

EGP60-S-E Vacuum Gripper(External Vacuum Source)

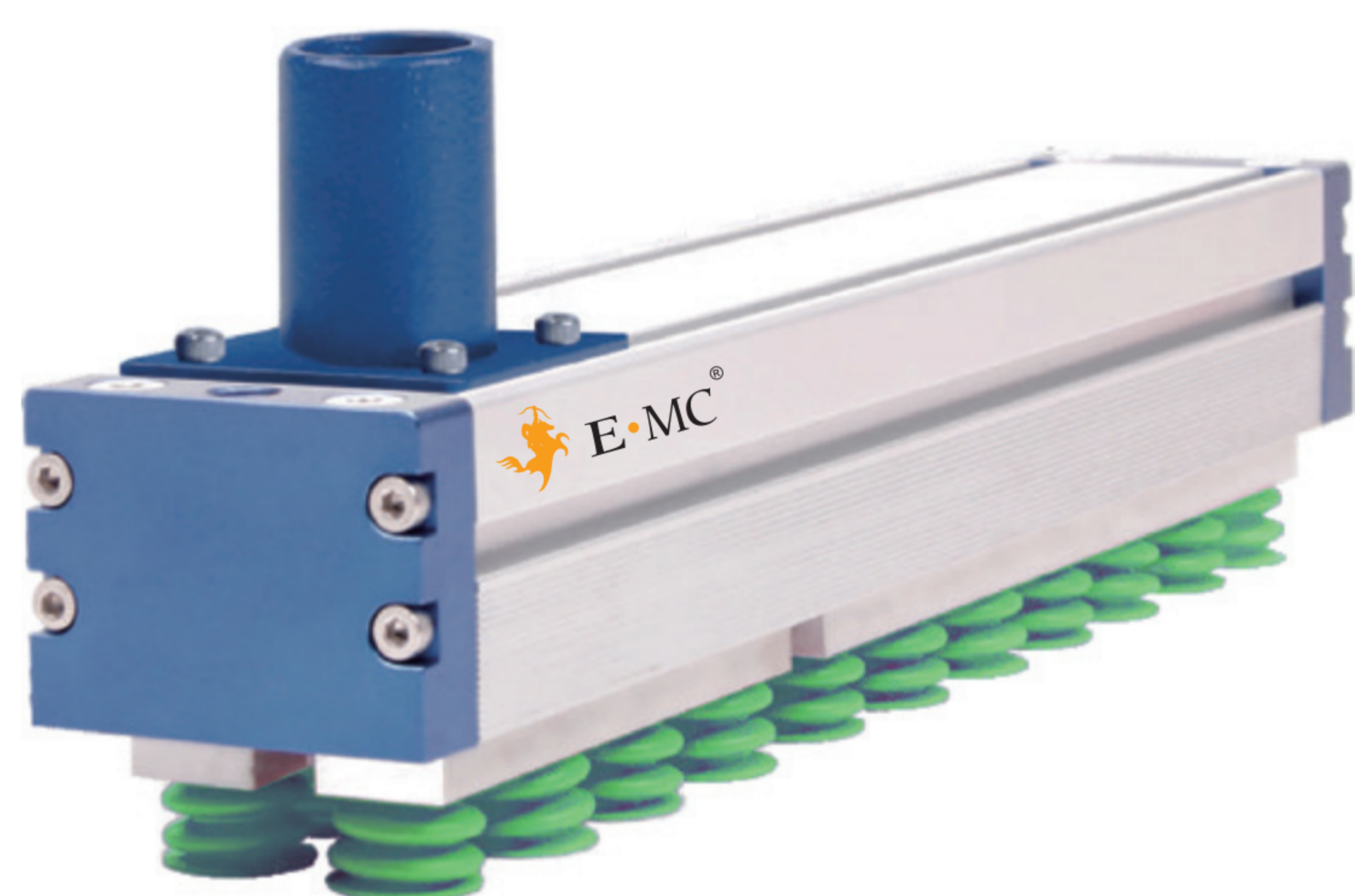

EGP60-S-E

Vacuum Gripper(External Vacuum Source)



Product Features

- Suitable for different industry products grabbing, meet various specifications.
- Flexible selection of standard or customized gripper, suction of different sizes can be freely combined and used.
- Optional self-closing valve technology can solve workpieces with large vacuum leakage, uneven surface, different sizes and geometric shapes
- Vacuum source can be connected to an external vacuum generator, suitable for using with electrically driven vacuum devices (blowers or vacuum pumps)
- Modular design for easy maintenance.
- The interface is reserved, and functional components can be directly added to the gripper to optimize the process, protect the environment and save energy.
- The material is aluminum alloy, factory plastic and carbon fiber composite material, which has the characteristics of high strength and light weight.
- Easy to install, with T-type removable mounting slider, available for fixing grippers as well as for mounting or mounting sensors.
- Rubber gasket accessory for quick replacement.

How to Order?

Series No.	Gripper Width	Gripper Length	Valve Technology	Suction-hole Type	Gripper Diameter	Vacuum Source
EGP: Vacuum gripper	60:60mm	285:285mm 355:355mm 401:401mm 516:516mm 608:608mm 701:701mm	V:Self-closing valve L:Flow valve S:High-speed valve	3:Three rows embedded module	S20: Gripper diameter 20mm	E: Connection interface for external vacuum generator

Order Example:EGP series vacuum gripper, gripper width 60mm, gripper length 520mm, self-closing valve, three rows embedded module, gripper diameter 20mm, external vacuum generator. EPR code is:EGP60-520V-3S20-E

Gripper Accessory Series No.

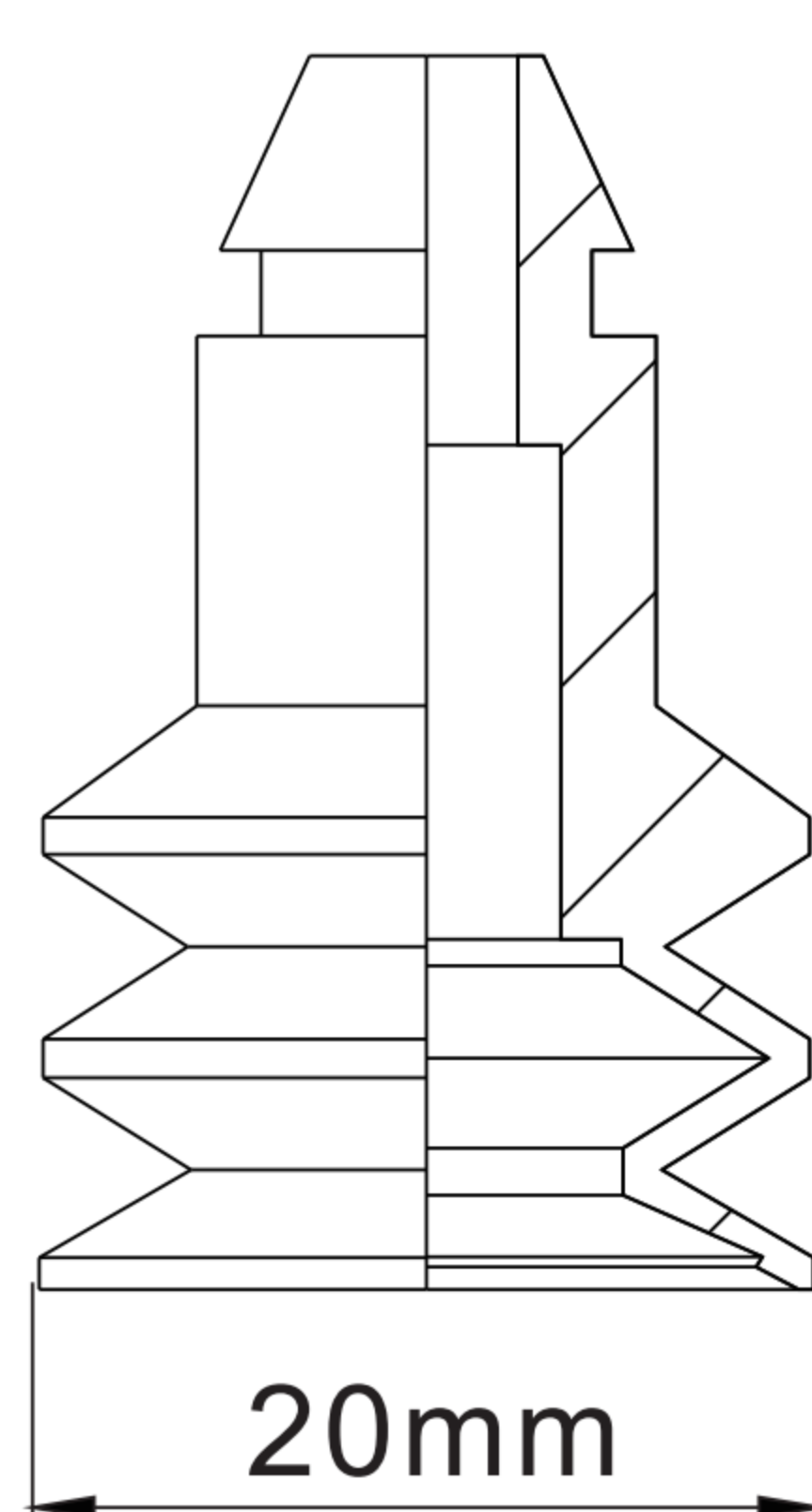

Gripper Accessory Series No: 20
 Gripper diameter 20mm
 Gripper uses 3 rows
 Suction-hole Type: 3

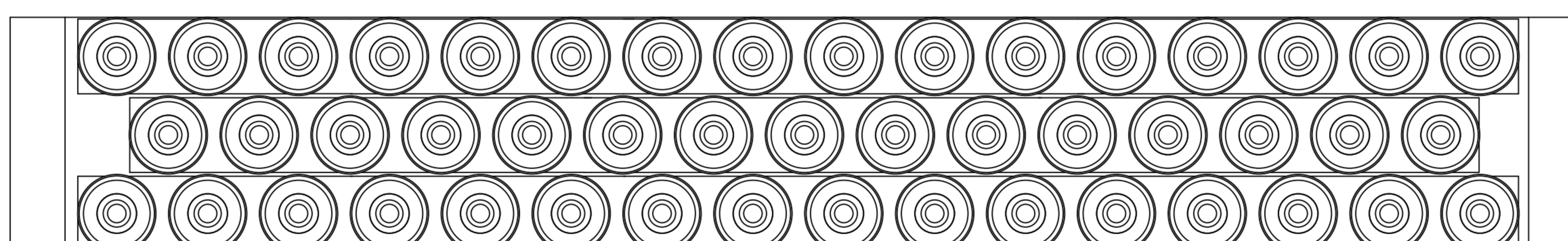

EGP60-S-E

EGP60-S-E Vacuum Gripper(External Vacuum Source)

Performance Parameter

Model	Suction-hole Type	Gripper Type	Gripper Number	Required Pumping Volume (L/min)	Vacuum Degree (kPa)	Suction Force N(-40kPa)	Weight (kg)
EGP60-285V-3S20-E	3	S20	41	160	-40	167	1
EGP60-355V-3S20-E	3	S20	47	200	-40	214	1.1
EGP60-401V-3S20-E	3	S20	56	220	-40	246	1.3
EGP60-516V-3S20-E	3	S20	62	300	-40	324	1.6
EGP60-608V-3S20-E	3	S20	74	340	-40	387	1.8
EGP60-701V-3S20-E	3	S20	86	400	-40	449	2
EGP60-816V-3S20-E	3	S20	101	460	-40	528	2.3
EGP60-909V-3S20-E	3	S20	113	520	-40	591	2.6
EGP60-1001V-3S20-E	3	S20	125	600	-40	653	2.8
EGP60-1117V-3S20-E	3	S20	140	650	-40	732	3.1
EGP60-1209V-3S20-E	3	S20	152	700	-40	794	3.3
EGP60-1301V-3S20-E	3	S20	164	750	-40	857	3.6

Main Dimension

Dimension: [mm]

Model	A	B	C	D	H1	H2	W	L
EGP60-285V-3S20-E	60(32)	44	50	44	45	35	60	285
EGP60-355V-3S20-E	60(32)	44	50	44	45	35	60	355
EGP60-401V-3S20-E	60(32)	44	50	44	45	35	60	401
EGP60-516V-3S20-E	60(32)	44	50	44	45	35	60	516
EGP60-608V-3S20-E	60(32)	44	50	44	45	35	60	608
EGP60-701V-3S20-E	60(32)	44	50	44	45	35	60	701
EGP60-816V-3S20-E	60(32)	44	50	44	45	35	60	816
EGP60-909V-3S20-E	60(32)	44	50	44	45	35	60	909
EGP60-1001V-3S20-E	60(32)	44	50	44	45	35	60	1001
EGP60-1117V-3S20-E	60(32)	44	50	44	45	35	60	1117
EGP60-1209V-3S20-E	60(32)	44	50	44	45	35	60	1209
EGP60-1301V-3S20-E	60(32)	44	50	44	45	35	60	1301

