

EGP60-S-A Vacuum Gripper(Built-In Vacuum Source)

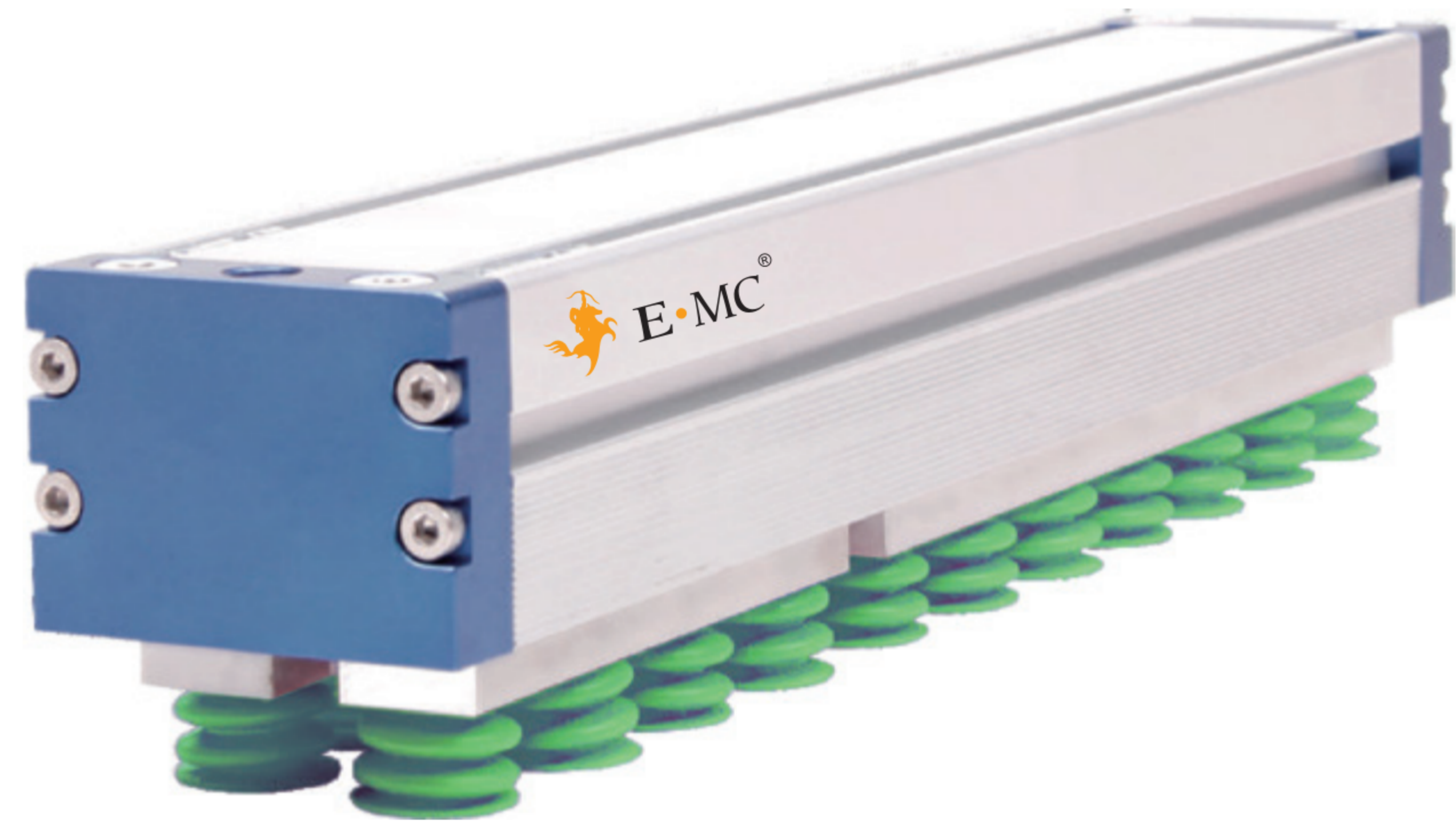

EGP60-S-A

Vacuum Gripper(Built-In Vacuum Source)



Product Features

- Suitable for different industry products grabbing, meet various specifications.
- Flexible selection of standard or customized gripper, suction of different sizes can be freely combined and used..
- Optional self-closing valve technology can solve workpieces with large vacuum leakage, uneven surface, different sizes and geometric shapes.
- Vacuum source uses a built-in plug-in vacuum generator, lower air consumption, greater vacuum flow, shorter vacuum build-up time.
- Integrated plug-in vacuum generating device, which can be individually configured and quickly disassembled according to changing working conditions.
- Modular design for easy maintenance.
- The interface is reserved, functional components can be directly added to the gripper, optimize the process, environmental protection and energy saving.
- The material is aluminum alloy, engineering plastic and carbon fiber composite material, which is high strength and light weight.
- Easy to install, with T-type removable mounting slider, available for fixing grippers as well as for mounting or mounting sensors.
- Rubber gasket accessory for quick replacement.

How to Order?

Series No.	Gripper Width	Gripper Length	Valve Technology	Suction-hole Type	Gripper diameter	Vacuum Source
EGP: Vacuum gripper	60:60mm	285:285mm 355:355mm 401:401mm 516:516mm 608:608mm 701:701mm	V:Self-closing valve L:Flow valve S:High-speed valve	3:Three rows embedded module	S20: Gripper diameter 20mm	A:Built-in vacuum generator
		816:816mm 909:909mm 1001:1001mm 1117:1117mm 1209:1209mm 1301:1301mm				

Order Example:EGP series vacuum gripper, gripper width 60mm, suction length 520mm, self-closing valve, three rows embedded module, gripper diameter 20mm, built-in vacuum generator. EPR code is:EGP60-520V-3S20-A

Gripper Accessory Series No.

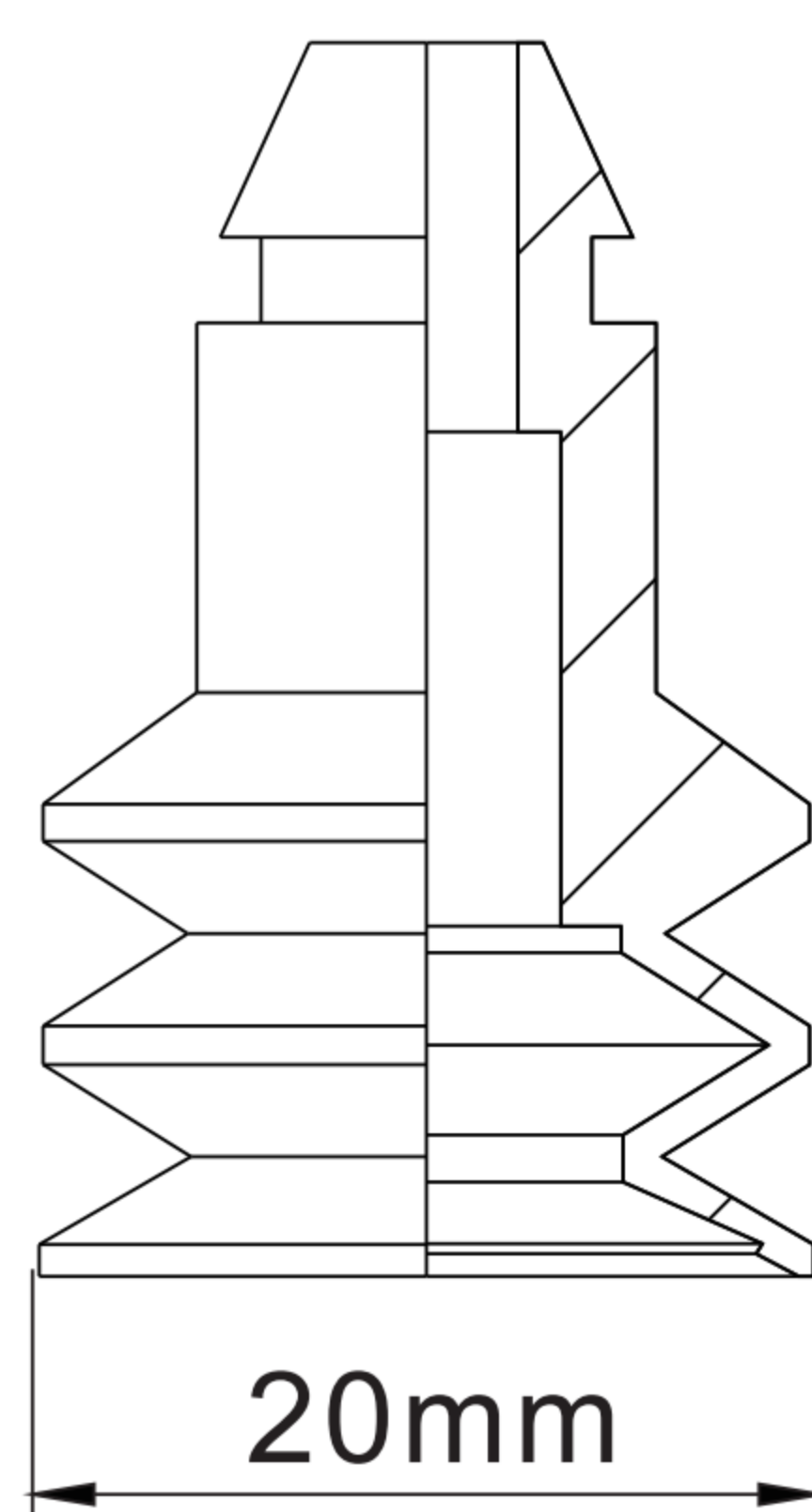

Gripper Accessory Series No: 20

Gripper diameter 20mm
Gripper uses 3 rows
Suction-hole Type: 3

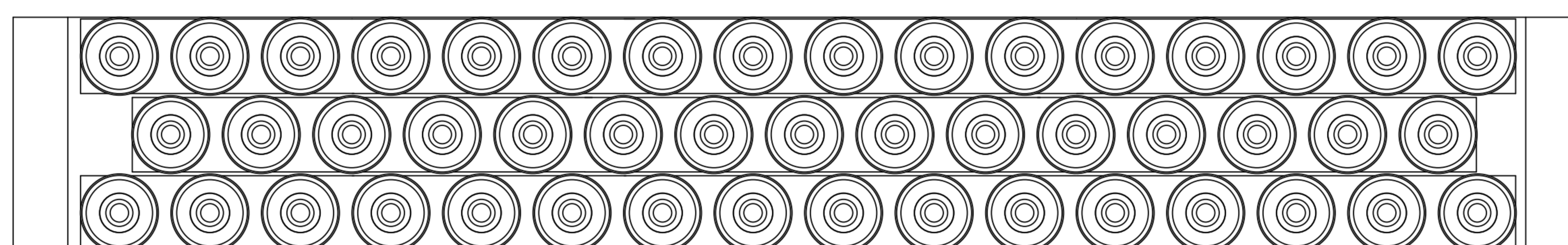

EGP60-S-A

EGP60-S-A Vacuum Gripper(Built-In Vacuum Source)

Performance Parameter

Model	Suction-hole Type	Gripper Type	Gripper Number	Supply Gas Pressure(Bar)	Gas Consumption (L/min)	Vacuum Degree (kPa)	Vacuum Flow (L/min)	Suction Force N(-60kPa)	Weight (kg)
EGP60-285V-3S20-A	3	S20	32	4~6	200	-60	700	167	1
EGP60-355V-3S20-A	3	S20	41	4~6	200	-60	700	214	1.5
EGP60-401V-3S20-A	3	S20	47	4~6	200	-60	700	246	1.6
EGP60-516V-3S20-A	3	S20	62	4~6	200	-60	700	324	1.9
EGP60-608V-3S20-A	3	S20	74	4~6	200	-60	700	387	2.2
EGP60-701V-3S20-A	3	S20	86	4~6	200	-60	700	449	2.4
EGP60-816V-3S20-A	3	S20	101	4~6	400	-60	1400	528	2.7
EGP60-909V-3S20-A	3	S20	113	4~6	400	-60	1400	591	2.9
EGP60-1001V-3S20-A	3	S20	125	4~6	400	-60	1400	653	3.2
EGP60-1117V-3S20-A	3	S20	140	4~6	400	-60	1400	732	3.5
EGP60-1209V-3S20-A	3	S20	152	4~6	400	-60	1400	794	3.7
EGP60-1301V-3S20-A	3	S20	164	4~6	400	-60	1400	857	3.9

Main Dimension

Dimension: [mm]

Model	B	H1	H2	W	L
EGP60-285V-3S20-A	44	45	35	60	285
EGP60-355V-3S20-A	44	45	35	60	355
EGP60-401V-3S20-A	44	45	35	60	401
EGP60-516V-3S20-A	44	45	35	60	516
EGP60-608V-3S20-A	44	45	35	60	608
EGP60-701V-3S20-A	44	45	35	60	701
EGP60-816V-3S20-A	44	45	35	60	816
EGP60-909V-3S20-A	44	45	35	60	909
EGP60-1001V-3S20-A	44	45	35	60	1001
EGP60-1117V-3S20-A	44	45	35	60	1117
EGP60-1209V-3S20-A	44	45	35	60	1209
EGP60-1301V-3S20-A	44	45	35	60	1301

